

Grenze

# Erdgeschoss 1/100

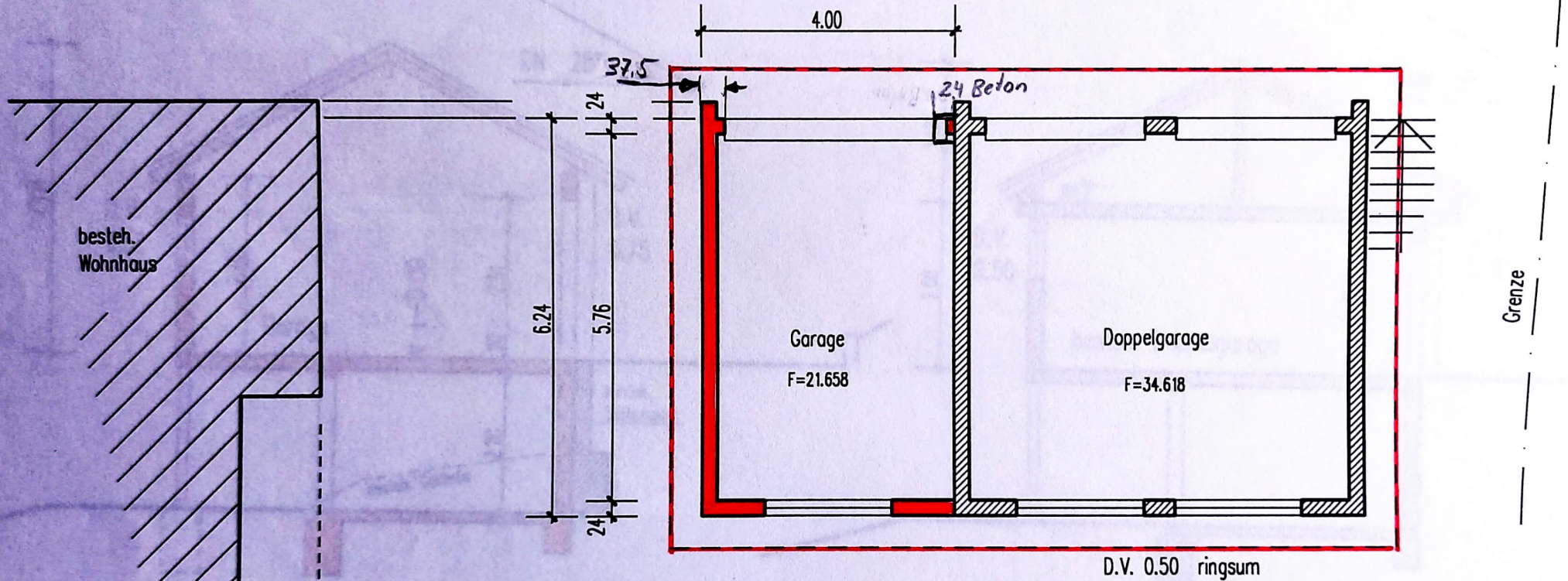

besteh.  
Wohnhaus

Garage

F=21.658

Doppelgarage

F=34.618

D.V. 0.50 ringsum

Grenze

BV.

Anerkannt Bauherr :

Starz.-Felldorf

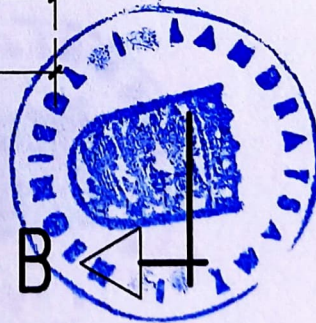
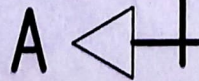
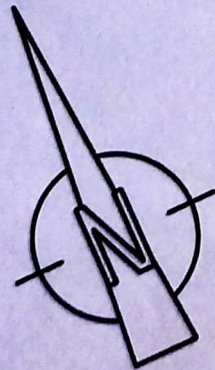

Gefertigt, den 07.02.1997

Anton Beuter

Bauzeichner

Weitenburgerstr. 20/1

72181 Starzach-Börstingen

Tel. 074 57/49 40

*Beut*