

H/B = 297 / 420 (0.12m²)

Allplan 2018

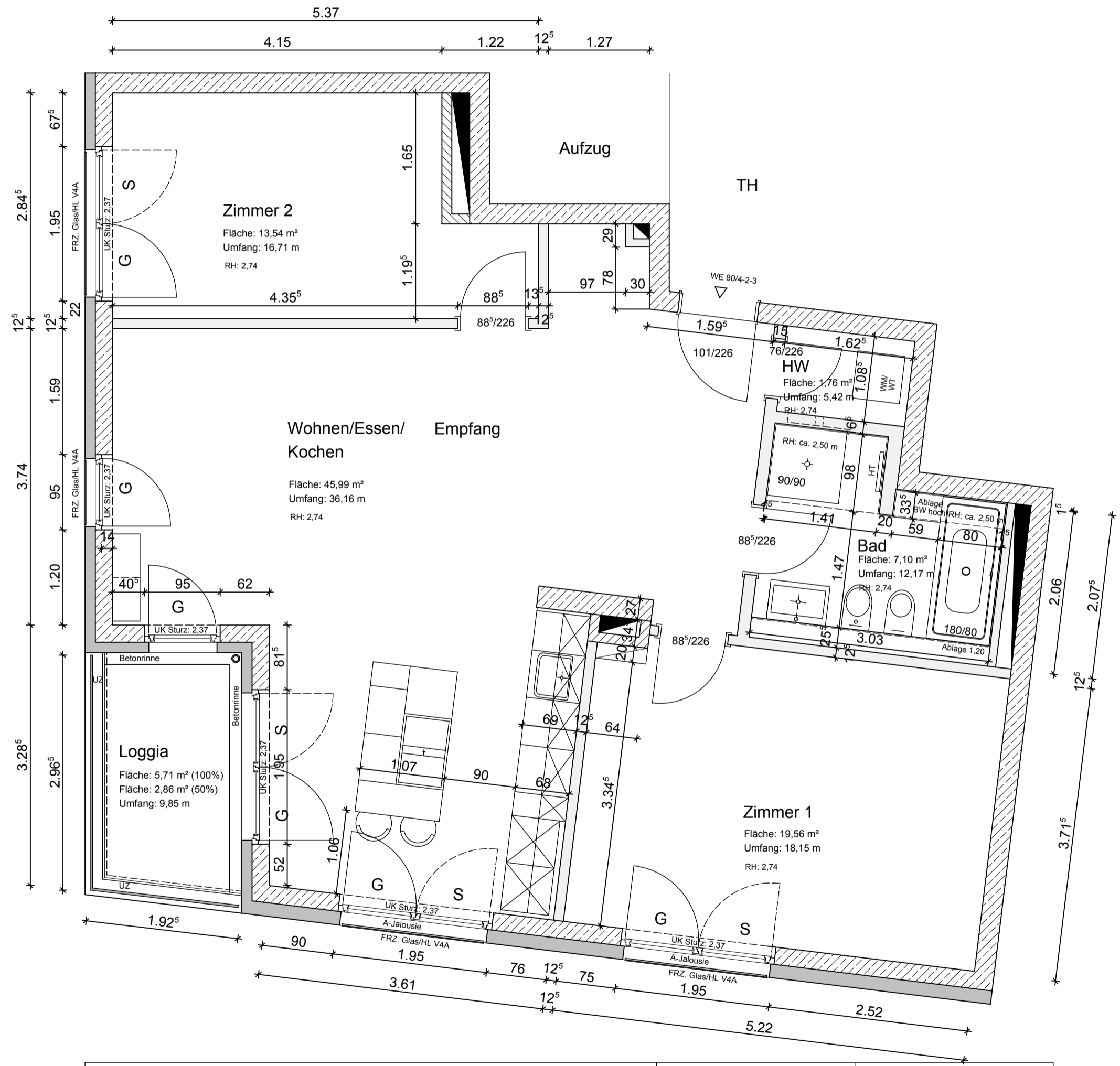

ALTE JAKOBSTRASSE 48 (AJ 48) 10179 BERLIN MITTE	WE80/ 4-2-3/ 2.OG M 1:50	<h1>AJ48</h1>
helge schulz architekten 2018	Wohn-/NFL: 90,81 m ² (50% Loggia) 93,66 m ² (100% Loggia) Fertigmassse Ausbau	